



## VEU Series

Residential  
Elevators



GMV North America

# THE NEXT NEW HOME APPLIANCE

For the past 60 years GMV has led the elevator world in the development and manufacture of hydraulic vertical transportation systems. With over 850,000 installations worldwide, GMV works with independent elevator companies to deliver the ultimate home elevator. We are committed to delivering a safe and reliable elevator manufactured in Canada.

## ELEVATORS, NOT LIFTS

We manufacture and supply elevators. Elevators should not be confused with lifts. Knowing the difference between a home elevator and a home lift will ensure your customer can make the best decision for their needs.

- Elevators are able to transport more than one person at a time. Most lifts are designed to transport one person.
- Lifts and platform lifts are limited in the vertical distance they can travel. If you have a multi-level home this means the homeowner may need to transfer to another lift at each level. Elevators provide an uninterrupted, continuous ride from the basement to the upper floors.
- VEU home elevators are built with the same technology and safety features as commercial elevators but require a much smaller footprint.
- The investment in a home elevator will serve the homeowner for many years and can adapt to the homeowners changing needs over time.

## GMV AUTOMATIC DOORS

All GMV VEU series residential elevators *only* come equipped with automatic landing doors and cab doors. This is a safety consideration and eliminates the risk of injury that is associated with landing swing doors and cab gates. Our elevators meet the  $\frac{3}{4}$ " x 3" and  $\frac{3}{4}$ " x 4" code requirements.

Automatic doors give the homeowner exceptional convenience, eliminating all accessibility issues related to swing doors and manual gates on the car.

## RELIABLE COMPACT DRIVE SYSTEM

The MINI Drive can fit in the hoistway (shaft) for a machine room less (MRL) arrangement or in a machine room outside the hoistway (shaft). The Drive also incorporates the world renowned 3010 control valve that provides the ultimate in smooth transitions in the up and down travel.

## GLOBAL COMPANY WITH A LOCAL SMILE

GMV is the world's leading supplier of elevator systems. You can enjoy the expertise behind their elevator products without sacrificing the convenience of local support, installation, service and maintenance.

GMV elevators are serviced through the largest elevator company network - The Independent Elevator Industry. This local connection in your community creates the valuable link that we call GLOCAL - Global supply, locally supported.

Our GMV Advantage Partners install only non-proprietary elevators. This translates to savings for the homeowner over the life of the elevator.



## FAST, TROUBLE-FREE INSTALLATION AND ON-TIME DELIVERY

GMV has tried to address the factors that impact critical installation milestones:

- a. Harnesses are pre-wired and fully tested prior to delivery eliminating troubleshooting on site during installation and inspection by authorities having jurisdiction.
- b. The pre-manufactured and cleaned "speed piping system" provides the elevator installation crew with a precise piping system that doesn't require any on-site manufacturing.
- c. Prior to delivery all VEU series non-proprietary elevators are equipped with pre-manufactured and fully tested plug-and-play wiring.

Many other tools are standard to simplify installation and provide on-time delivery of the elevator.

The 100% Complete VEU elevator package is delivered to the site with all parts, hardware, fittings, and fixtures on one skid. No need for any off-site runs to the local hardware store or waiting for factory deliveries for missing components.

Everything you need for a problem-free installation is included - down to the last nut and bolt. We even include the oil. Nothing has been forgotten.

The President of GMV mandated the 100% Complete format as a way to address the on-site frustration many of our customers have experienced with some competitors packages.



## FRONT ONLY (INLINE) - SIDE RAIL WALL SPECIFICATIONS

LH SHOWN

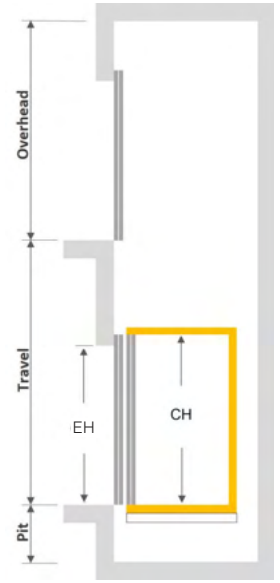
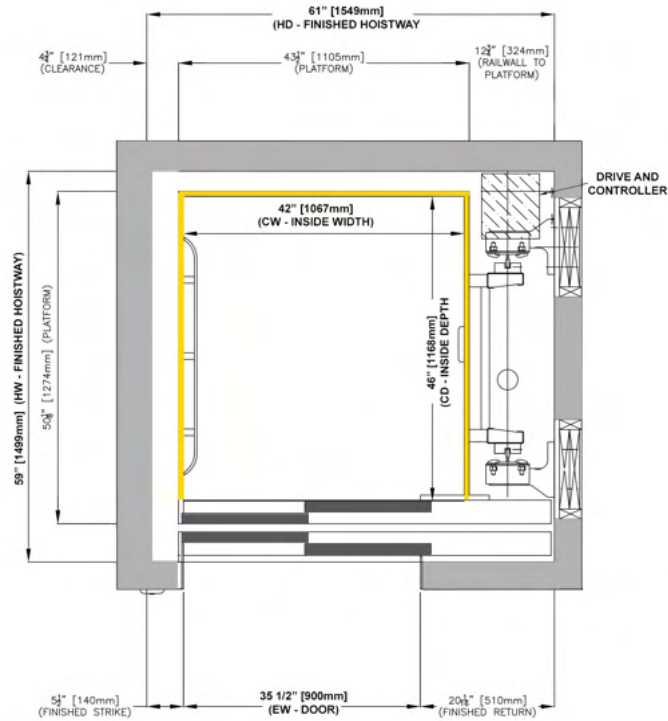

HOISTWAY ELEVATION

		NOMINAL CAB CLEAR INSIDE			ENTRANCE OPENING		HOISTWAY		MIN OVERHEAD
Capacity (Duty Load) lbs (kg)	Door Config.	CW in (mm)	CD in (mm)	CH ft-in (mm)	EW ft-in (mm)	EH ft-in (mm)	HW in (mm)	HD in (mm)	in (mm)
950 (431)	3 Panel	32"-42"* (813-1067)	42"-60"* (1067-1524)	6'-8" (2032)	2'-7 1/2" (800)	6'-8" (2032)	49"-59" (1245-1499)	56"-74" (1422-1880)	108" (2743)
				7'-0" (2134)	2'-11 1/2" (900)	7'-0" (2134)			112" (2845)
	2 Panel	36"-42"* (914-1067)	42"-60"* (1067-1524)	8'-0" (2438)	2'-11 1/2" (900)	8'-0" (2438)	53"-59" (1346-1499)	56"-74" (1422-1880)	120" (3048)

Nominal Speed ft/min (m/s)	Pit Depth in (mm)	Travel ft (mm)
40 fpm (0.2 m/s)	Minimum 8" (203mm)	49' (14934)

\* Customizable in 1" increments to a maximum of 15 sq. ft.  
Please note: All dimensions are subject to change.

## FRONT ONLY (INLINE) - REAR RAIL WALL - SPECIFICATIONS

LH SHOWN

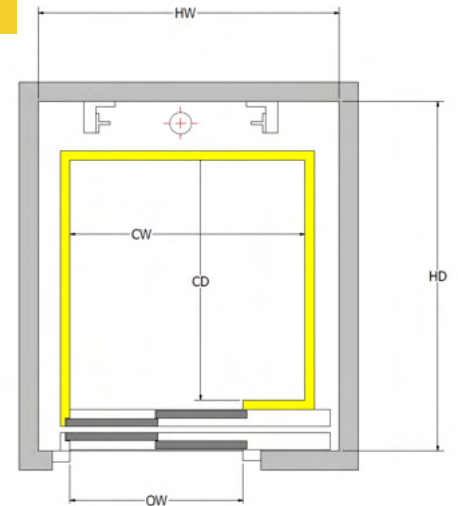

		NOMINAL CAB CLEAR INSIDE			ENTRANCE OPENING		HOISTWAY		MIN OVERHEAD
Capacity (Duty Load) lbs (kg)	Door Config.	CW in (mm)	CD in (mm)	CH ft-in (mm)	EW ft-in (mm)	EH ft-in (mm)	HW in (mm)	HD in (mm)	in (mm)
950 (431)	3 Panel	39"-58"* (991-1473)	27"-41"* (686-1041)	6'-8" (2032)	2'-7½" (800)	6'-8" (2032)	49"-69" (1245-1753)	49"-63" (1245-1600)	108" (2743)
				7'-0" (2134)	2'-11½" (900)	7'-0" (2134)			112" (2845)
	2 Panel	39"-58"* (991-1473)	27"-41"* (686-1041)	8'-0" (2438)	2'-11½" (900)	8'-0" (2438)	60½"-69" (1537-1753)	49"-63" (1245-1600)	120" (3048)

## FRONT AND SIDE (90 DEGREE) - SPECIFICATIONS

		NOMINAL CLEAR INSIDE			ENTRANCE OPENING		HOISTWAY		MIN OVERHEAD
Capacity (Duty Load) lbs (kg)	Door Config.	CW in (mm)	CD in (mm)	CH ft-in (mm)	EW in (mm)	EH ft-in (mm)	HW in (mm)	HD in (mm)	in (mm)
950 (431)	2 Panel	50" (1270)	42" (1067)	8'-0" (2438)	35 ½" (900)	8'-0" (2438)	66" (1677)	66" (1677)	120" (3048)

Nominal Speed ft/min (m/s)	Pit Depth in (mm)	Travel ft (mm)
40 fpm (0.2 m/s)	Minimum 8" (203)	49' (14935)

\* Customizable in 1" increments to a maximum of 15 sq. ft.  
Please note: All dimensions are subject to change.

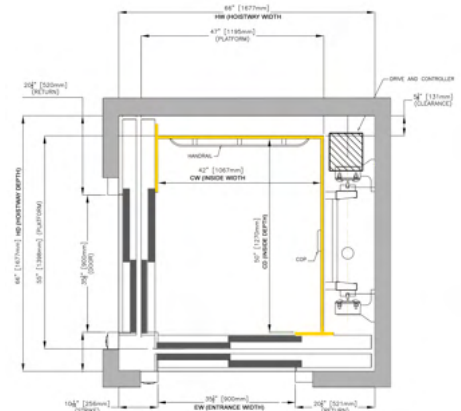

## FRONT AND REAR (THRU CAB) - SPECIFICATIONS

LH SHOWN

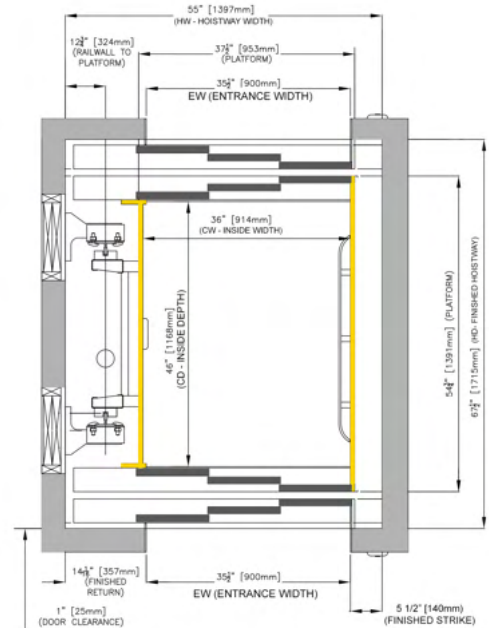

		NOMINAL CAB CLEAR INSIDE			ENTRANCE OPENING		HOISTWAY		MIN OVERHEAD
Capacity (Duty Load) lbs (kg)	Door Config.	CW in (mm)	CD in (mm)	CH ft-in (mm)	EW ft-in (mm)	EH ft-in (mm)	HW in (mm)	HD in (mm)	in (mm)
950 (431)	3 Panel	32"-42"* (813-1067)	39"-58"* (991-1473)	6'-8" (2032)	2'-7½" (800)	6'-8" (2032)	49"-59" (1245-1499)	60"-79" (1524-2007)	108" (2743)
				7'-0" (2134)	2'-11½" (900)	7'-0" (2134)			112" (2845)
	2 Panel	36"-42"* (914-1067)	39"-58"* (991-1473)	8'-0" (2438)	2'-11½" (900)	8'-0" (2438)	53"-59" (1346-1499)	60"-79" (1524-2007)	120" (3048)

Nominal Speed ft/min (m/s)	Pit Depth in (mm)	Travel ft (mm)
40 fpm (0.2 m/s)	Minimum 8" (203mm)	49' (14934)

\* Customizable in 1" increments to a maximum of 15 sq. ft.  
Please note: All dimensions are subject to change.

## ARCHITECTURAL CAB FINISHES AND FIXTURE FINISHES

### CUSTOMIZABLE CAB INTERIORS



### CAB HAND RAILS



Available options:

- Brushed stainless steel
- Brushed brass
- Antique bronze
- Wood: Cherry, Maple, Oak

### CONTROL OPERATING PANEL (COP)



### COP BUTTON



Available options:

- Stainless Steel & Blue Halo
- Stainless Steel & Red Halo

### LAMINATE OPTIONS

Standard Wood Veneer



Maple



Oak



Cherry

Special Order Wood Veneers



Walnut

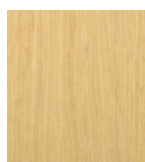

White Oak

## VEU SERIES PRODUCT SPECIFICATIONS

The Complete Elevator Package is Non-Proprietary

### GENERAL SPECIFICATION

Elevator Type: Machine Room Less (MRL) or Machine Room (MR)  
Drive: Cantilever 2:1 indirect arrangement with 80 mm single stage jack  
Capacity (Duty Load): 950 lbs (431 kg)  
Gross Load: 2000 lb (910 kg)  
Speed: 40 fpm (0.2 m/s)  
Max. Travel: Maximum 49' (14935 mm)  
Floors Served: Up to 5

### CAB CLEAR INSIDE (NOMINAL)

Maximum cab area: 15 sq ft (1.4 sq m) in 1" and 2" increments

### Available Arrangements

Front Only (Inline)  
Front and Rear (Thru-Cab)  
Front and Side (90°)

### STANDARD CAB FEATURES

Cab Walls: Unfinished wood veneer to be finished on site  
Cab Ceiling: Unfinished wood veneer to be finished on site  
Cab Operating Panel (COP): Brushed stainless steel  
Cab Indicator: Directional arrows on car entrance strike jamb  
Telephone: Integrated telephone with speaker and keypad  
Handrail: Brushed stainless steel  
    Brushed brass  
    Antique bronze  
    Wood - Cherry, Maple, Oak  
Cab Doors: 2-speed or 3-speed fully automatic sliding doors  
    Powder coated beige or stainless steel

### STANDARD LANDING FEATURES

Landing Entrance: Fully automatic 2 or 3 speed sliding doors  
Landing Hall Stations: Flat plate push button

### OPTIONAL FEATURES

Glass cab walls  
Custom fixtures  
Interior cab finishes

### MECHANICAL EQUIPMENT

Guide Rails: T89B  
Car Frame: 601 Cantilever  
Drive: Mini Fluitronic™ 3.5 HP  
Motor/Pump: Submersible for quiet operation  
Jack: 3.15" (80 mm) dia auxiliary power 120V 15A

### STANDARD SAFETY FEATURES

Emergency Power: Battery UPS  
Emergency Lowering: Automatic lowering in the event of power outage  
Emergency Lighting  
Emergency Stop Switch  
Automatic Door Interlocks: CSA/UL approved hoistway door interlocks  
Line Rupture Valve (LRV): Flow control safety valve  
Auto Relevel (anti creep): Car will relevel to floor if not level with landing  
Door Detector: Micro scan motion detector. Full length light curtain detects objects in front of the doors.

### CONTROLS

Elevator Controller: CSA-approved micro controller  
Wiring: Plug and Play  
    Fully factory tested

### ELEVATOR CONSTRUCTION REQUIREMENTS

#### Elevator Hoistway (Shaft) Requirements

Pit Depth: Minimum 8" (203 mm)  
Overhead\*: Minimum height 108" (2744 mm)  
Power Requirements: 208v or 230v 1PH 30A  
Construction Drawings: Drawings provided to General Contractor  
*Cab floor to be finished by others.*

*\*Overhead requirements may change based on a number of factors.  
Please contact your sales representative or GMV Advantage Partner for more information.*



GMV North America

GMV-NA  
North American Head Office  
Ontario, Canada  
+1(855) 653-0215  
info@gmv-na.com  
www.gmv-na.com

VEU Series 2206